

# SEAMING MACHINE

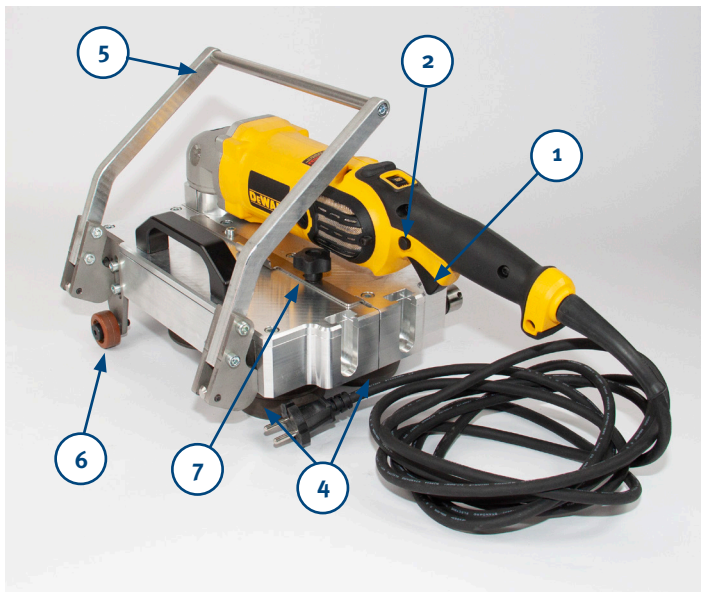

- 1 On / Off switch
- 2 Interlock switch
- 3 Speed pre-adjustment: **Not over 1.000 rpm!**
- 4 Seaming rolls
- 5 Lever for opening and closing the seaming appliance
- 6 Bearing rolls (adjustable for profile N50 and N65)
- 7 Lever to set the distance plate
- 8 Interlock switch without function

The version is supplied with a cable as standard.  
Cordless devices only after prior approval available.

## SEAMING MACHINE

### General:

- With **coated material** use in any case **plastic rolls**.
- Take care that the size of the eye is 21 mm – 23 mm.
- **WARNING:** Machine is running autonomously. Don't walk nearby in the sheet.
- The maximum speed is **1.000 rpm** (revolutions per minute). **Maximum setting! Do not increase the speed!**
- Prior usage, check the correct adjustment of Bearing rolls for 65 mm or 50 mm seam height.
- To assure a long machine life please clean the machine before and after every using process.
- Oil the machine frequently.
- Any questions – please contact BEMO.

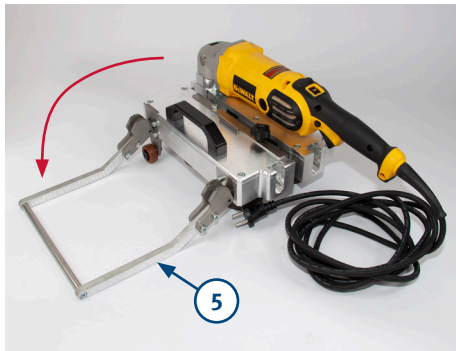

### 1. How to open the seaming machine:

Turn the lever (5) down.

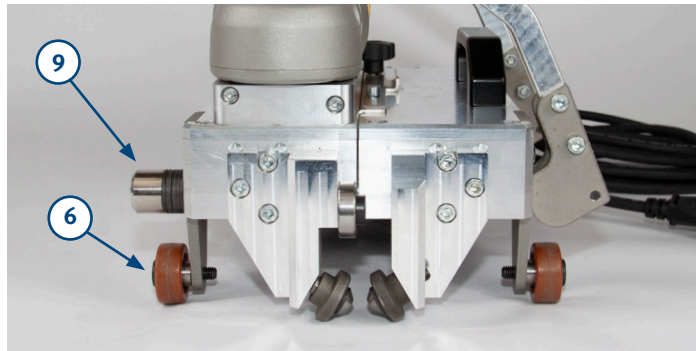

### 2. How to place seaming machine on the seam:

First prepare the seam with the handseaming tool. Then place the open machine on the seam, so that bearing rolls (6) have contact with the sheet and the seaming rolls (4) are enclosing the big eye. By using the lever (7) you can move the distance plate to regulate the gap. This enables to adjust the thickness of the seam (up to 2 mm). Further adjustments can be made with the tensioning nuts.(9)



### 3. How to close the seaming machine:

For closing the lever (5) use the tap mode. Once the machine is closed completely, it can be used in continuous mode. At the end of the panels machine need to be switched off and be taken off the panel.



### 4. Changing the rollers:

- For changing the rollers machine should be closed.
- After opening the locking nuts the rolls can be taken off and get replaced.
- Locking nuts should be just hand tight.



### Important Note:

Do not push the interlock switch (8) in any case.